

# 37 LANGSTON®

## REPLACEMENT KNIVES & ACCESSORIES

FEATURING   
**WOLVERINE™**



**ZENITH CUTTER**  
A FISHER BARTON COMPANY

\*Langston is a registered trademark Sun Automation Group.

# 37 LANGSTON® REPLACEMENT KNIVES



\*FEATURING WOLVERINE

## STANDARD MALE SLOT KNIVES FOR 3/8 INCH SLOTTING



2 INCH				
PART #	M3542-S	M3542	M3538-S	M3538
DESCRIPTION	SERRATED MALE WITH TIP	MALE WITH TIP	SERRATED MALE WITHOUT TIP	MALE WITHOUT TIP



3 INCH				
PART #	M3510-S	M3510	M3534-S	M3534
DESCRIPTION	SERRATED MALE WITH TIP	MALE WITH TIP	SERRATED MALE WITHOUT TIP	MALE WITHOUT TIP



4 INCH				
PART #	M3544-S	M3544	M3501-S	M3501
DESCRIPTION	SERRATED MALE WITH TIP	MALE WITH TIP	SERRATED MALE WITHOUT TIP	MALE WITHOUT TIP



5 INCH				
PART #	M3515-S	M3515	M3511-S	M3511
DESCRIPTION	SERRATED MALE WITH TIP	MALE WITH TIP	SERRATED MALE WITHOUT TIP	MALE WITHOUT TIP



6 INCH				
PART #	M3546-S	M3546	M3536-S	M3536
DESCRIPTION	SERRATED MALE WITH TIP	MALE WITH TIP	SERRATED MALE WITHOUT TIP	MALE WITHOUT TIP



8 INCH				
PART #	M3514-S	M3514	M3513-S	M3513
DESCRIPTION	SERRATED MALE WITH TIP	MALE WITH TIP	SERRATED MALE WITHOUT TIP	MALE WITHOUT TIP



10 INCH				
PART #	M35522-S	M35522	M3550-S	M3550
DESCRIPTION	SERRATED MALE WITH TIP	MALE WITH TIP	SERRATED MALE WITHOUT TIP	MALE WITHOUT TIP



**ZENITH CUTTER**  
A FISHER BARTON COMPANY

WHEN IT'S MAKE OR BREAK.™



## GLUEHEAD MALE SLOT KNIVES FOR 3/8 INCH SLOTTING

\*FEATURING WOLVERINE



6 INCH				
PART #	M35005-S	M35005	M351001-S	M351001
DESCRIPTION	SERRATED MALE WITH TIP, ELONGATED SLOT	MALE WITH TIP, ELONGATED SLOT	SERRATED MALE WITHOUT TIP, ELONGATED SLOT	MALE WITHOUT TIP, ELONGATED SLOT



8 INCH				
PART #	M35512-S	M35512	M35511-S	M35511
DESCRIPTION	SERRATED MALE WITH TIP, BEVEL AND EXTENDED SLOT	MALE WITH TIP, BEVEL AND EXTENDED SLOT	SERRATED MALE WITHOUT TIP, BEVEL AND EXTENDED SLOT	MALE WITHOUT TIP, BEVEL AND EXTENDED SLOT



12 INCH				
PART #	M35571-S	M35571		
DESCRIPTION	SERRATED DINO TIPPED	DINO TIPPED MALE		

## MALE GLUEHEAD ASSEMBLY

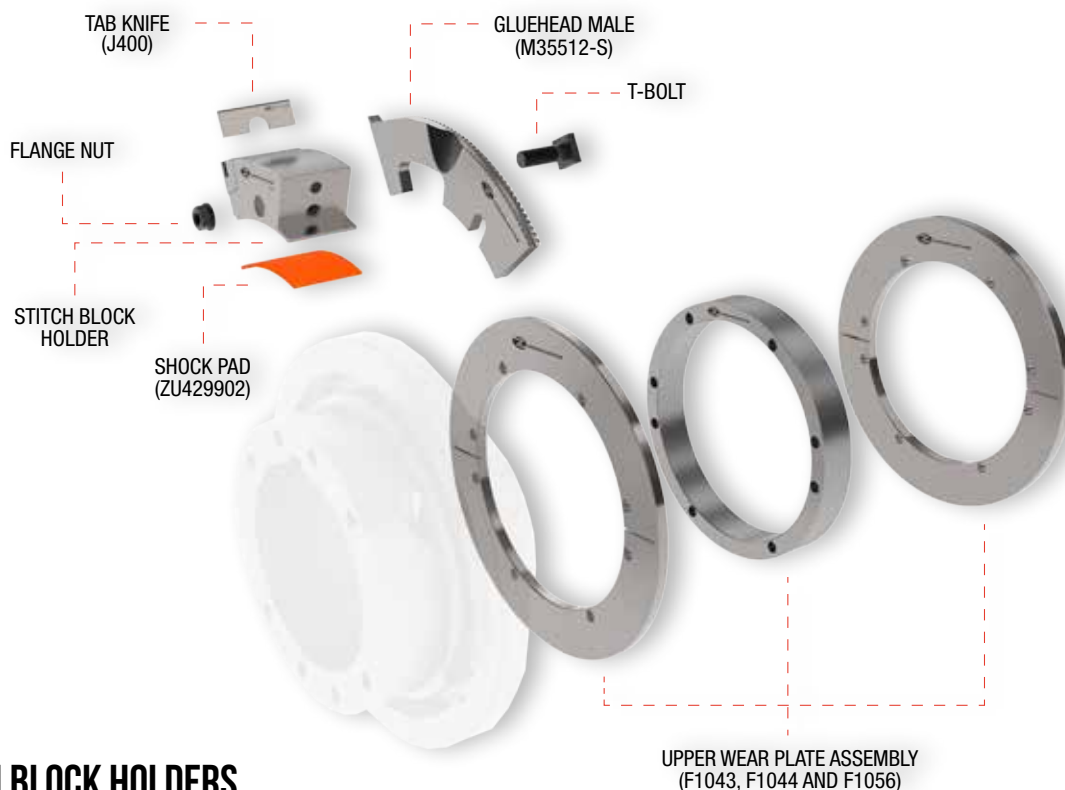

## STITCH BLOCK HOLDERS



STEEL ANVIL SYSTEM		
PART #	L29	L30
DESCRIPTION	TRAIL TAB BLOCK ASSEMBLY	LEAD TAB BLOCK ASSEMBLY

FOR A FULL LIST OF ZENITH PRODUCTS, CALL 800-223-5202

# 37 LANGSTON® REPLACEMENT KNIVES

## ▶ FEMALE SLOT KNIVES

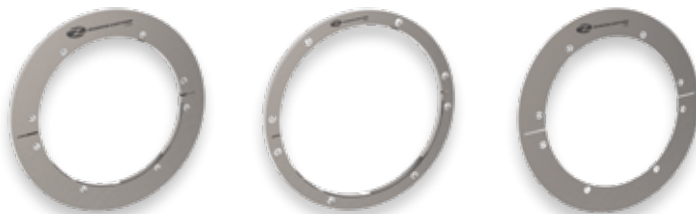

PART #	F324	F463	F926
OEM #	254479B		415641
DIMENSIONS	10.615 X 7.876 X .375	9.125 X 7.876 X .377	10.615 X 7.876 X .094
CATEGORY	STANDARD	SPACER	THIN/PINCH RING

## ▶ STANDARD FEMALE ASSEMBLY

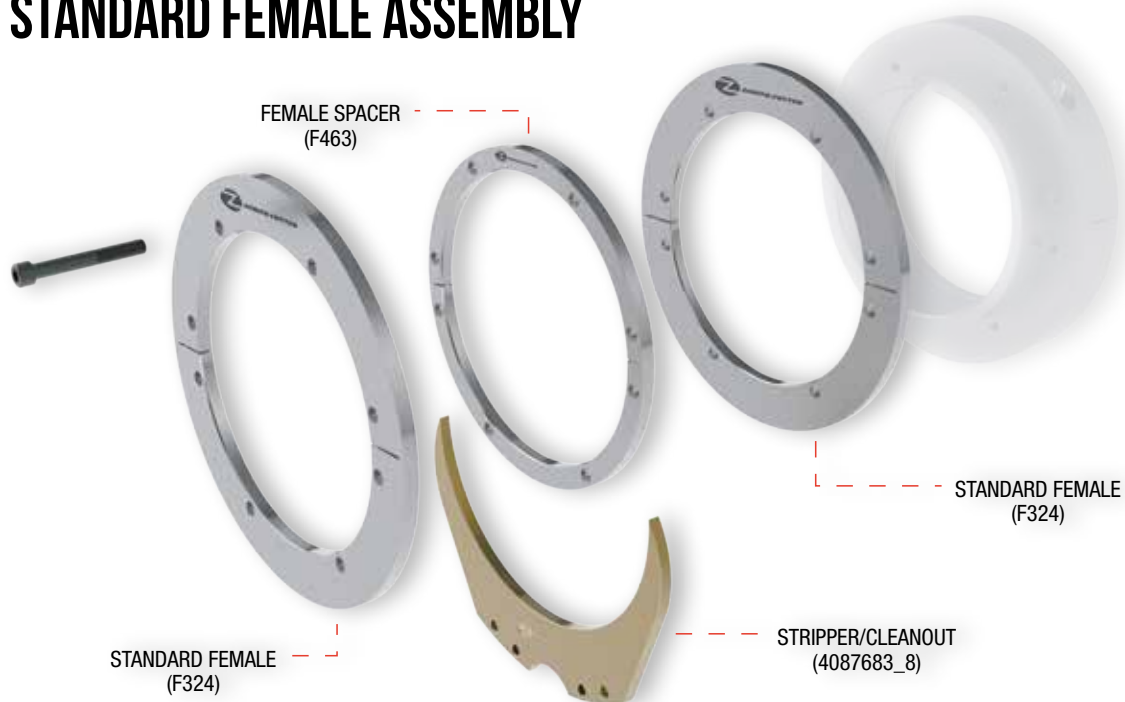

## ▶ ANVILS



PART #	A106	A85
DESCRIPTION	2" TAB ANVIL	1 5/8" TAB ANVIL
DIMENSIONS	10.615 X 7.876 X 2	10.615 X 7.876 X 1.625

## ▶ TRIM KNIVES



G1018	G884
THREADED UPPER TRIM KNIFE	THREADED LOWER TRIM KNIFE
12.25 X 9.001 X .375	11 X 7.876 X .375

## TAB KNIVES

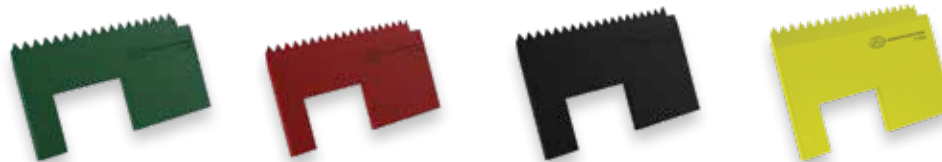

### 1-5/8 INCH FOR URETHANE ANVIL

PART #	P1886	P1887	P1888	P1889
DESCRIPTION	B FLUTE TAB KNIFE	C FLUTE TAB KNIFE	BC FLUTE TAB KNIFE	AC FLUTETAB KNIFE
DIMENSIONS	1-5/8 X .813 X .060	1-5/8 X .875 X .060	1-5/8 X .97 X .060	1-5/8 X 1.05 X .060

### 2 INCH FOR URETHANE ANVIL

PART #	P531	P532	P533	P534-AC
DESCRIPTION	B FLUTE TAB KNIFE	C FLUTE TAB KNIFE	BC FLUTE TAB KNIFE	AC FLUTE TAB KNIFE
DIMENSIONS	2 X .813 X .060	2 X .875 X .060	2 X .97 X .060	2 X 1.05 X .060

### 2 INCH FOR STEEL ANVIL



PART #	J158	J397	J400	ZU429902
OEM #	412668-2	412668-1	412668-5	429902
DESCRIPTION	C FLUTE TAB KNIFE	B FLUTE TAB KNIFE	DOUBLE WALL TAB KNIFE, BC FLUTE	SHOCK PAD
DIMENSIONS	2 X .625 X .120	2 X .575 X .120	2 X .71 X .120	3 X 1.875 X .125



FEATURING...

# WOLVERINE™



Wolverine™ is the newest male slot knife from Zenith Cutter, featuring newly-engineered serrations designed specifically for over-recycled corrugate. Based on initial testing, the patent-pending Wolverine cuts better than any other male slot knife on the planet — meaning cleaner cuts and less mess.

FOR A FULL LIST OF ZENITH PRODUCTS, CALL 800-223-5202

# 37 LANGSTON® REPLACEMENT KNIVES

## WEAR PLATES



PART #	F1043	F1044	F1056	F899
OEM #	256190	256190	256190	256188
DESCRIPTION	UPPER WEAR PLATE 3 PIECE ASSEMBLY			LOWER WEAR PLATE
DIMENSIONS	10.75 X 7.501 X .375	10.75 X 7.501 X .5	8.75 X 7.501 X 1.21	10.125 X 7.876 X .312

## STRIPPER/CLEANOUT



PART #	4087683_8	4110543_8	4110553_8
DESCRIPTION	6.625 X 10 X .36	2.5 X 3.486 X .360	4.125 X 10.322 X .360

## FEED WHEEL



PART #	ZU12651
DESCRIPTION	3 X 2.25 X .787

## HARDWARE



### 1/2 INCH

PART #	1_2-31_2TB	1_2-11_2TB	1_2FNHEAVY
DESCRIPTION	1/2 X 3-1/2 T BOLT SQUARE HEAD	1/2 X 1-1/2 T BOLT SQUARE HEAD	1/2 FLANGE NUT (HEAVY DUTY)
DIMENSIONS	3.5 X 1/2	1.5 X 1/2	

### 3/8 INCH

PART #	3_8-21_2TB	3_8-11_8TB	3_8FNHEAVY
DESCRIPTION	3/8 X 2-1/2 T BOLT SQUARE HEAD	3/8 X 1-1/8 T BOLT SQUARE HEAD	3/8 FLANGE NUT (HEAVY DUTY)
DIMENSIONS	2.5 X 3/8	1.125 X 3/8	

# 37 LANGSTON®

## UPPER & LOWER SHAFT ASSEMBLY

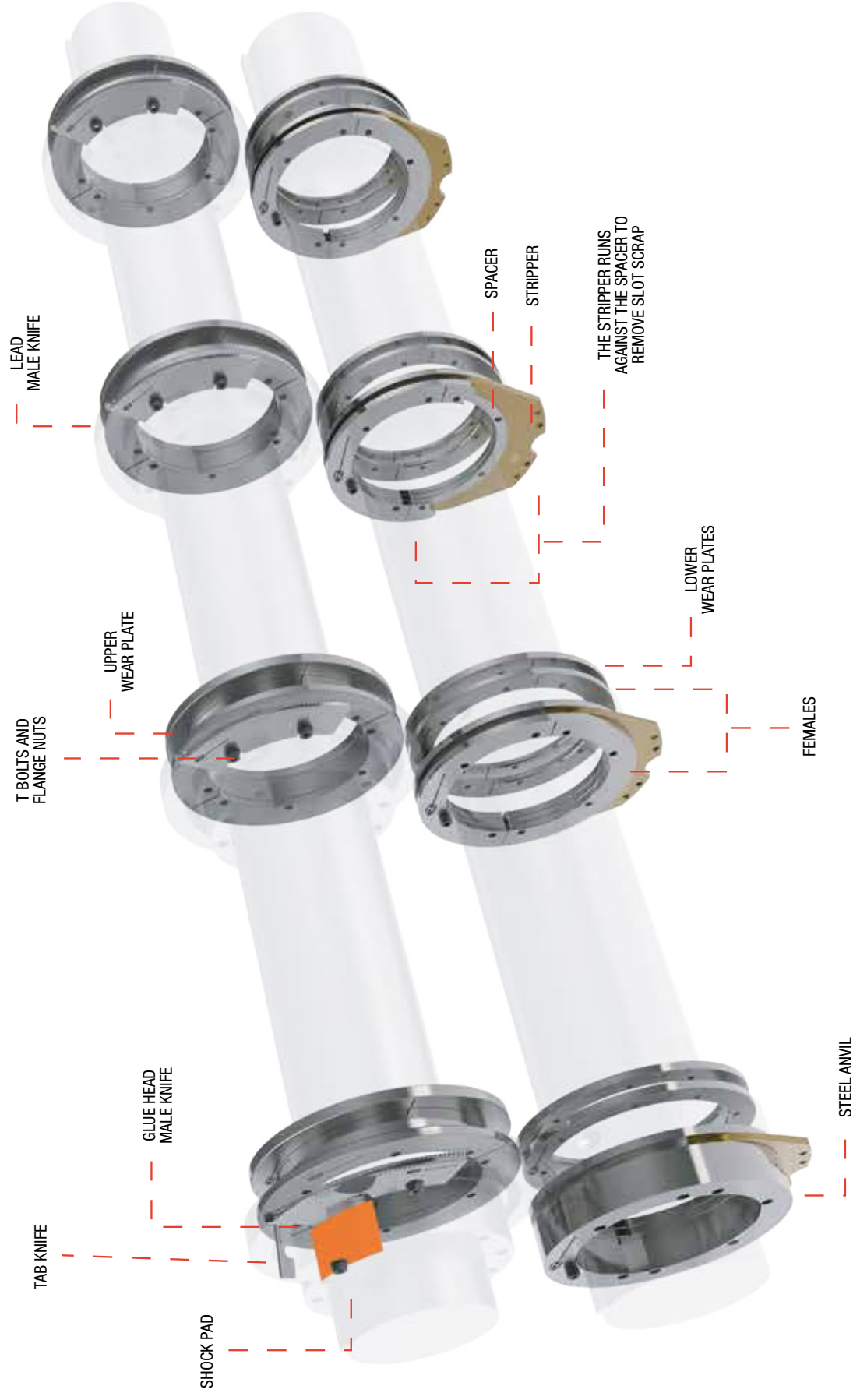

FOR A FULL LIST OF ZENITH PRODUCTS, CALL 800-223-5202



# 37 LANGSTON®

## WHEN IT'S MAKE OR BREAK.™



### BEST IN CLASS. GUARANTEED.

We guarantee our knives will perform, as well or, better than the rest. Why? Because making knives is what we do and we do it better than anyone else. Through extensive engineering and research, we make the best knives on the planet.



5200 Zenith Parkway  
Loves Park, IL 61111



815.282.5200  
800.223.5202 (US)  
800.228.5206 (Canada)



[zenithcutter.com](http://zenithcutter.com)



[sales@zenithcutter.com](mailto:sales@zenithcutter.com)



**ZENITH CUTTER**  
A FISHER BARTON COMPANY



**SMITHERS**  
QUALITY ASSESSMENTS