

66 WARD[®]

MODELS 15 & 16

Best in Class.
**KNIFE
 GUARANTEE**



**SERRATED TIP
 INCLUDED ON
 WOLVERINE KNIVES**



FEATURING WOLVERINE
 LEARN MORE ABOUT WOLVERINE
WWW.ZENITHCUTTER.COM/WOLVERINE

STANDARD MALE SLOT KNIVES (BODY HEIGHT 2.937")

	2 HOLES ≈ 2"		4 HOLES ≈ 3 7/8"	
	PART #	M7372-S	M7382-S	
DESCRIPTION	SERRATED MALE WITH TIP	SERRATED MALE WITHOUT TIP	SERRATED MALE WITH TIP	SERRATED MALE WITHOUT TIP
	6 HOLES ≈ 5 3/4"		8 HOLES ≈ 7 1/2"	
	PART #	M7376-S	M7386-S	
DESCRIPTION	SERRATED MALE WITH TIP	SERRATED MALE WITHOUT TIP	SERRATED MALE WITH TIP	SERRATED MALE WITHOUT TIP
	10 HOLES ≈ 9 1/4"		14 HOLES ≈ 12 1/2"	
	PART #	M7379-S	M7389-S	
DESCRIPTION	SERRATED MALE WITH TIP	SERRATED MALE WITHOUT TIP	SERRATED MALE WITH TIP	SERRATED MALE WITHOUT TIP

*NON-SERRATED KNIVES ARE AVAILABLE



ZENITH CUTTER
 A FISHER BARTON COMPANY

66 WARD® MODELS 15 & 16

▶ GLUEHEAD MALE SLOT KNIVES



9 1/4 INCH

PART #	M7320-S	M7321-S
DESCRIPTION	SERRATED MALE WITH TIP	SERRATED MALE WITHOUT TIP

*NON-SERRATED KNIVES ARE AVAILABLE

▶ FEMALE SLOT KNIVES



PART #	F374	F736	F375	F1788	F1883
DIMENSIONS	13.838 X 10.5 X .375	13.835 X 10.5 X .094	12.25 X 10.5 X .377	13.835 X 10.5 X .094	13.836 X 10.501 X .374
CATEGORY	STANDARD	THIN/PINCH RING	SPACER	DIRT GROOVE THIN/PINCH RING	STANDARD WITH DIRT GROOVE

▶ TRIM KNIVES



PART #	G879	G878
DESCRIPTION	UPPER TRIM KNIFE	LOWER TRIM KNIFE
DIMENSIONS	21.5 X 17.5 X .5	16.544 X 13 X .5

▶ STRIPPERS



PART #	C787323_8
DESCRIPTION	STRIPPER/CLEANOUT
DIMENSIONS	9.916 X .36

▶ GREASER ANVILS



PART #	ZU177053	ZU154789	ZU121733
DESCRIPTION	DUROMETER 65A	DUROMETER 75A	DUROMETER 85A

▶ STITCH ANVILS



PART #	ZU3289C	ZU3565C
DIMENSIONS	1.906 X .300	3 X .300

TAB KNIVES

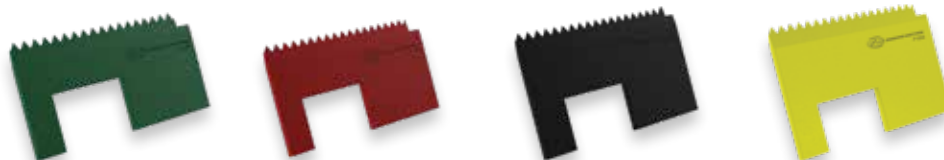

1-5/8 INCH FOR URETHANE ANVIL

PART #	P1886	P1887	P1888	P1889
DESCRIPTION	B FLUTE TAB KNIFE	C FLUTE TAB KNIFE	BC FLUTE TAB KNIFE	AC FLUTE TAB KNIFE
DIMENSIONS	1-5/8 X .813 X .060	1-5/8 X .875 X .060	1-5/8 X .97 X .060	1-5/8 X 1.05 X .060

2 INCH FOR URETHANE ANVIL

PART #	P531	P532	P533	P534-AC
DESCRIPTION	B FLUTE TAB KNIFE	C FLUTE TAB KNIFE	BC FLUTE TAB KNIFE	AC FLUTE TAB KNIFE
DIMENSIONS	2 X .813 X .060	2 X .875 X .060	2 X .97 X .060	2 X 1.05 X .060

URETHANE BLANKETS



Standard Width Example



Double Width Example

BARLOCK

PART #	ZU8660	ZU8661	ZU8660D
DESCRIPTION	STANDARD	STANDARD	DOUBLE WIDE
DIMENSIONS	9.937 X 0.315	10.000 X 0.315	20.000 X 0.315

PART #	ZU5661	ZU5662	ZU5703
DESCRIPTION	EQUALIZER	EQUALIZER	EQUALIZER
DIMENSIONS	9.937 X 0.315	10.000 X 0.330	9.937 X 0.313

PART #	ZU84660	ZU84661	ZU84660D
DESCRIPTION	SHAVEABLE	SHAVEABLE	SHAVEABLE DOUBLE WIDE
DIMENSIONS	9.937 X 0.420	10.000 X 0.420	19.874 X 0.420

PART #	ZU8666	ZU8668	ZU8669	ZU8687
DIMENSIONS	9.590 X 0.313	8.897 X 0.354	9.937 X 0.330	8.86 X 0.350

KNUCKLELOCK

PART #	ZU12294	ZU12294D	ZU80192A
DESCRIPTION	STANDARD	DOUBLE WIDE	ASTIN STYLE
DIMENSIONS	9.937 X 0.330	19.874 X 0.330	9.937 X 0.300

Standard Width Example



Double Width Example

PART #	ZU12295	ZU12295D
DESCRIPTION	SHAVEABLE	SHAVEABLE DOUBLE WIDE
DIMENSIONS	9.990 X 0.420	19.874 X 0.420

EQUALIZER IS A REGISTERED TRADEMARK OF DICAR®

FOR A FULL LIST OF ZENITH PRODUCTS, CALL 800-223-5202

66 WARD® MODELS 15 & 16

UPPER & LOWER SHAFT ASSEMBLY

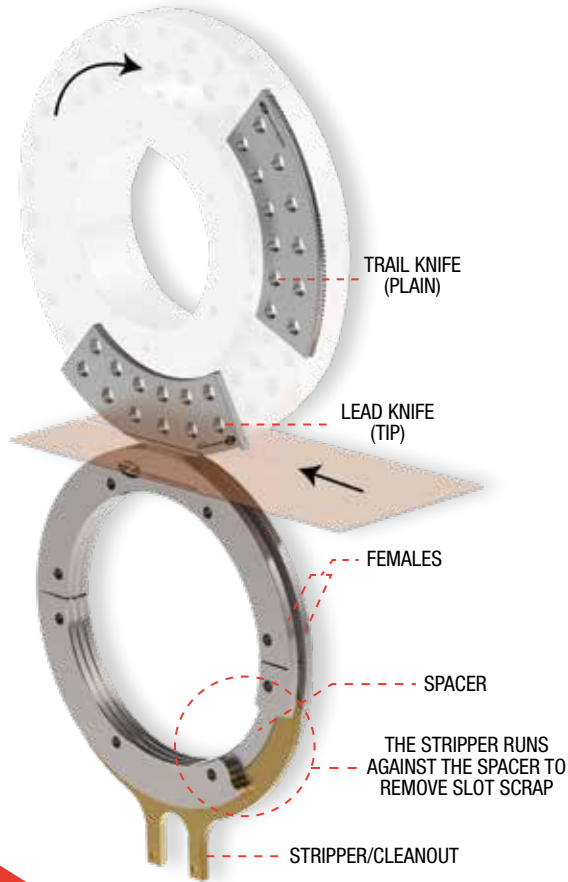

STANDARD FEMALE ASSEMBLY

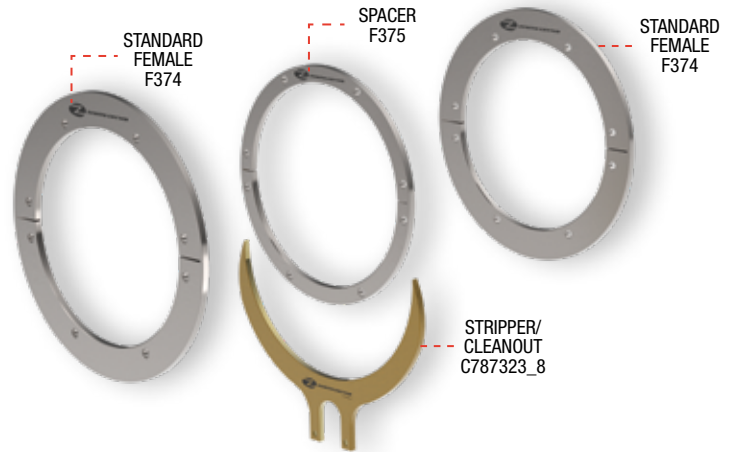

BEST IN CLASS. GUARANTEED.

We guarantee our knives will perform, as well or better than the rest. Why? Because making knives is what we do and we do it better than anyone else. Through extensive engineering and research, we make the best knives on the planet.

Best in Class.

**KNIFE
GUARANTEE**

5200 Zenith Parkway
Loves Park, IL 61111

815.282.5200
800.223.5202 (US)
800.228.5206 (Canada)

zenithcutter.com

sales@zenithcutter.com



ZENITH CUTTER
A FISHER BARTON COMPANY



SMITHERS
QUALITY ASSESSMENTS